

## A simple guide that explain how to secure mcHF pcb in SP3OSJ case

Cut from the walls of a box for electrical installation (thickness 2 mm) four pieces 1,5x1,5 cm.

Cut out the pieces in the shape of L so that they do not interfere with the UI buttons.

Drill holes 2.5 mm as shown in the following drawing

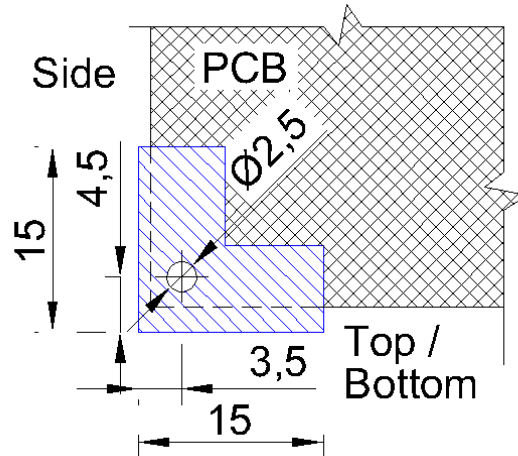

The pieces protrude from the pcb and enter in the groove of the front panel case, they are then spaced with 0,5 mm plastic washers to give the pcb the right position for the proper functioning of the front panel buttons.

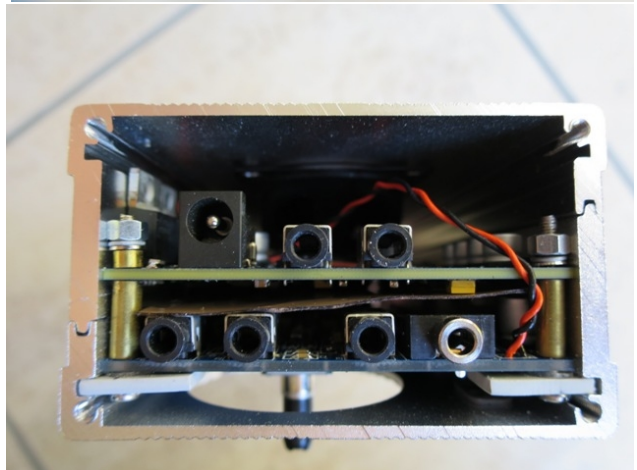
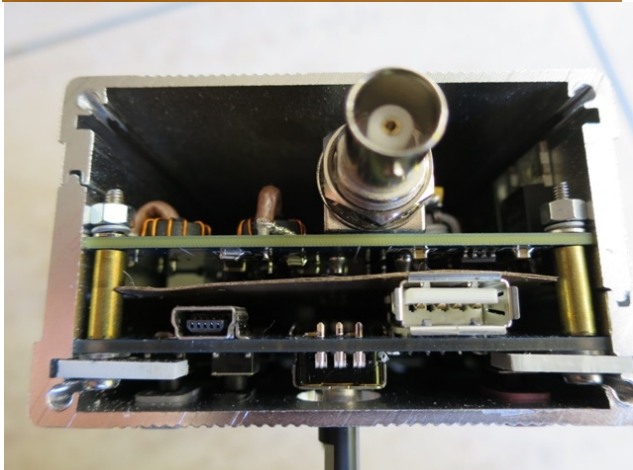
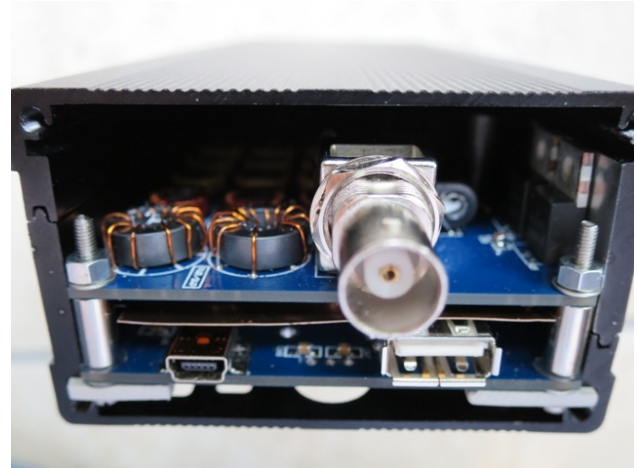
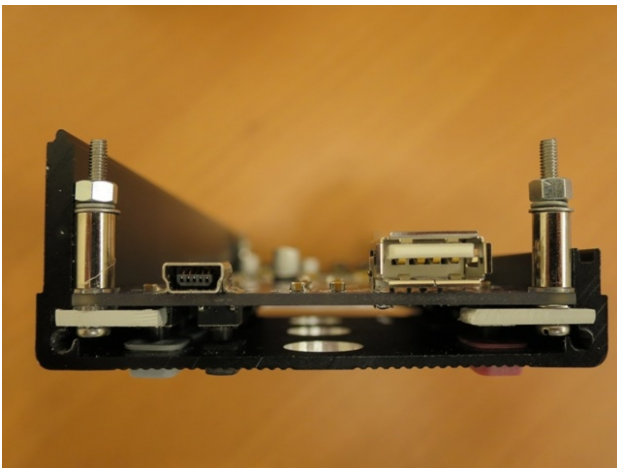

After Fixing the UI you can mount the RF on the UI using screw 2,5x20 mm, spacers 10 mm + 2 plastic washers 5x0,5 mm to reach 11 mm, or you can cut with a length of 11 mm brass tube diameter 4 mm used in airplane modeling as you can see in the photo.

All hardware was purchased from [www.TME.EU](http://www.TME.EU)

- The Bolt are M2.5X20/D965 vite; M2,5x20; Testa:cilindrica; Incisione:Phillips; acciaio ROHS
- The cylindrical standoff are DR315/2.6X10 Canotto distanziale; 10mm; cilindrico; ottone; nichel ROHS
- The metallic washer are B2.5/BN566 Rondella; rotonda;M2,5;D=5mm;h=0,5mm; ottone;Copertura:nichel ROHS
- The plastic washer are B3/BN1074 Rondella;rotonda;M3;D=7mm;h=0,5 mm; plastica; DIN:125A;BN:1074 ROHS

Once closed the case with the RF pcb mounted on the UI and the speaker inside you will sign the four mounting holes of the speaker and the four mounting holes of IC & Fet from the inner side and complete the job.

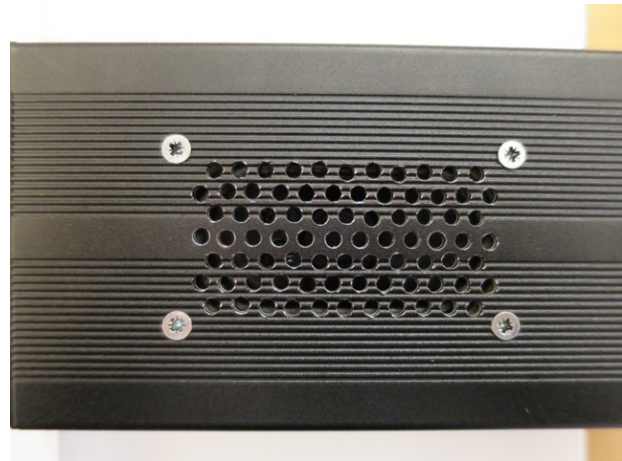
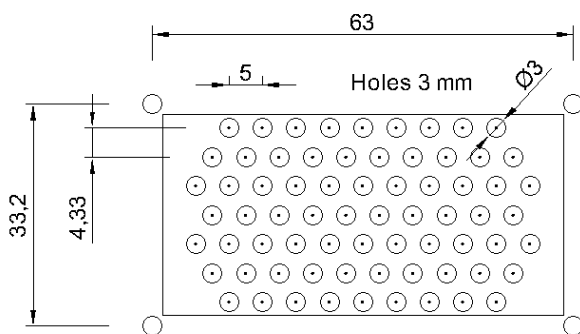

You can find in this directory the autocad file “Side Panel & speaker Holes mask.dwg” with the mask of the holes to be provided for the speaker and the side panel.

You can print the mask and superimpose the chassis with packaging tape by aligning the four holes made previously, and implement the other holes directly on the mask.

Also for the side panels you can use the same procedure, using the four side holes for alignment, before taping wrapping.

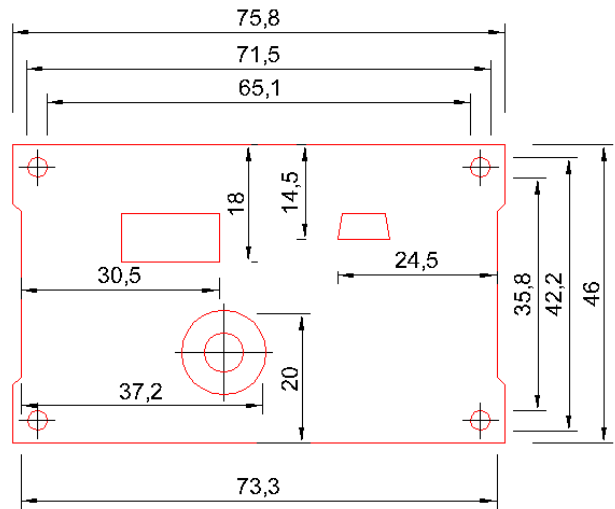
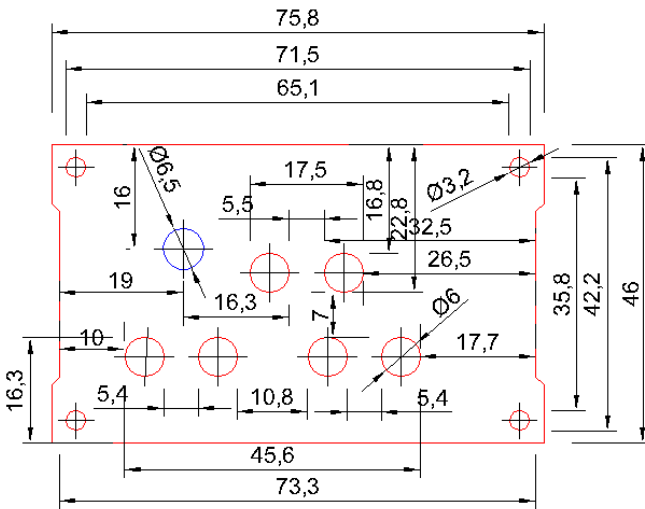
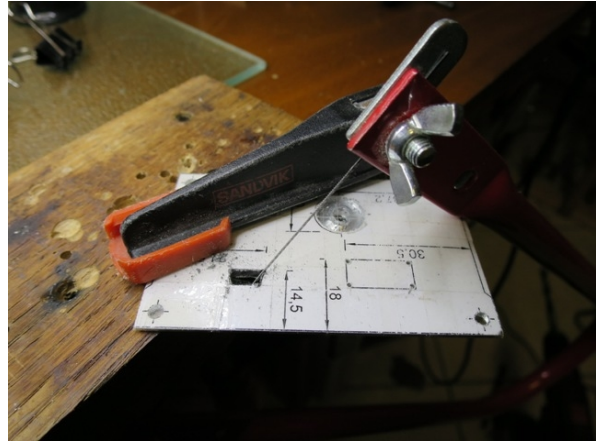
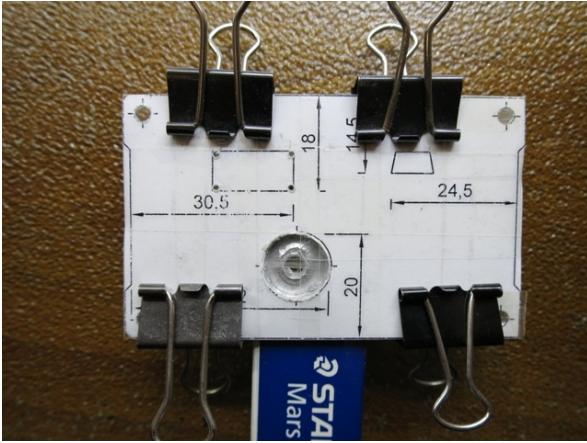

Good work and good luck to all of you .

'73 IZ6MAF Paolo